

PERMANENT MAGNET SHAKER

DYN-PM-100

DynaLabs permanent magnet shakers create motion by magnets and coils pushing and pulling each other, similar to the technology used in loudspeakers.



ALL-IN-ONE SHAKER

What sets our shakers apart is the integrated amplifier, which makes them incredibly easy to use. The built-in electronics can also generate sinus signals, enabling simple tests without the need for vibration controllers. The DYN-PM-20 and PM-100 models come with an integrated amplifier and a highly flexible sine wave signal generator, allowing frequency adjustment from 1 Hz to 12,000 Hz. With their lightweight design and powerful performance, they are the ideal solution for vibration testing.



Advantages

- Lightweight, durable, portable and easy to use
- Adjustable trunnion base provides high degree of flexibility
- Broad frequency range
- Embedded power amplifier and signal generator



Application Areas

- Vibration testing of small parts
- Sensor calibration
- Modal testing
- Shock testing
- Fatigue and resonance testing



DYNALABS MUHENDISLIK LTD STI

Ostim OSB Mah. 100 Yil Bulvarı Ostim
No:55B/11 Yenimahalle 06374 Ankara
TURKEY

Phone: +90 312 386 21 89

Mail: dynalabs@dynalabs.com.tr

Web: www.dynalabs.com.tr

DynaLabs PERMANENT MAGNET SHAKER

DYN-PM-100

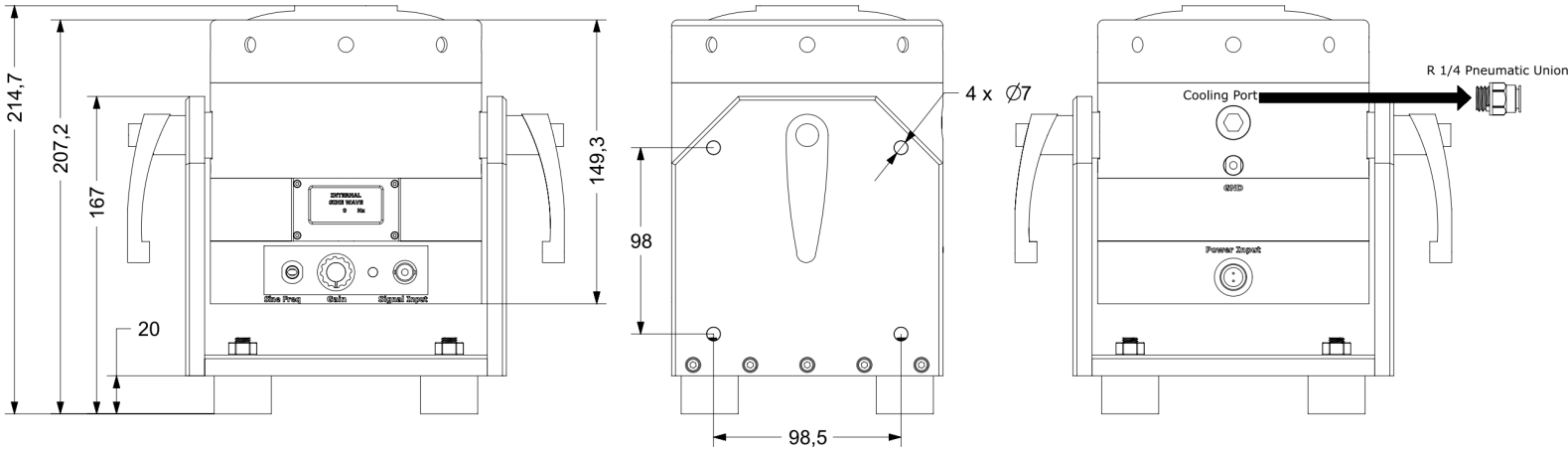
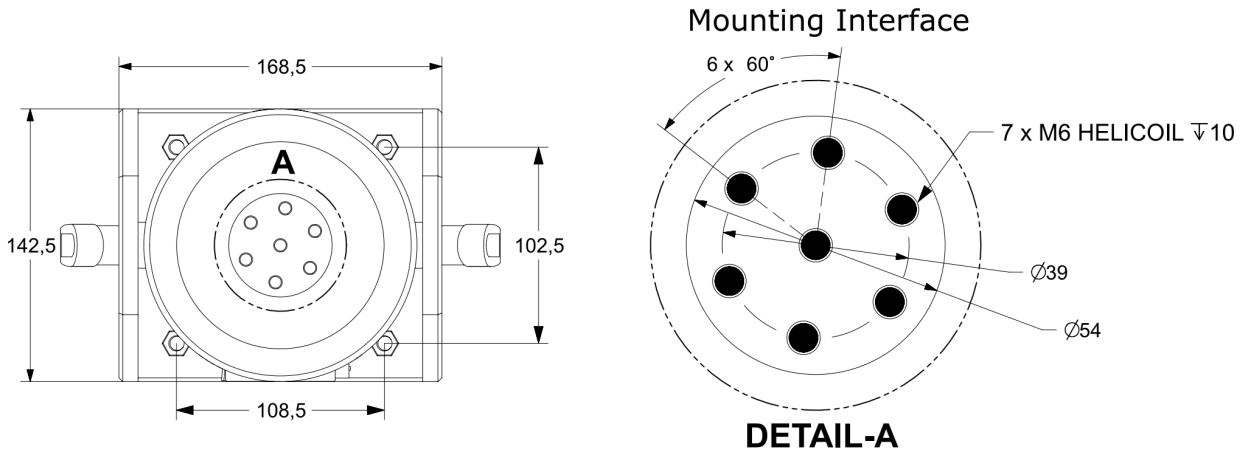

Output Force (Sinus)	Frequency Range	Max Payload (Vertical)	Displacement (P-P)	Maximum Acceleration	Shaker Weight	Cooling System	Armature Weight
100 N	0-7.5 kHz	1.5 kg	10 mm	60 g	7.3 kg	Natural Convection	170 gr
Operating Temp. Range	Suspension	Maximum Input Current	AMPLIFIER	Power Supply Voltage	Power Supply Current	External Signal Voltage Level	Max Velocity
5-35 °C	Carbon Fiber	6A (RMS)	INTERNAL	24 V (DC)	5 A	1 VAC (PEAK)	1 m/s



DYNALABS MUHENDISLIK LTD STI

Ostim OSB Mah. 100 Yil Bulvarı Ostim
No:55B/11 Yenimahalle 06374 Ankara
TURKEY

Phone: +90 312 386 21 89

Mail: dynalabs@dynalabs.com.tr

Web: www.dynalabs.com.tr